

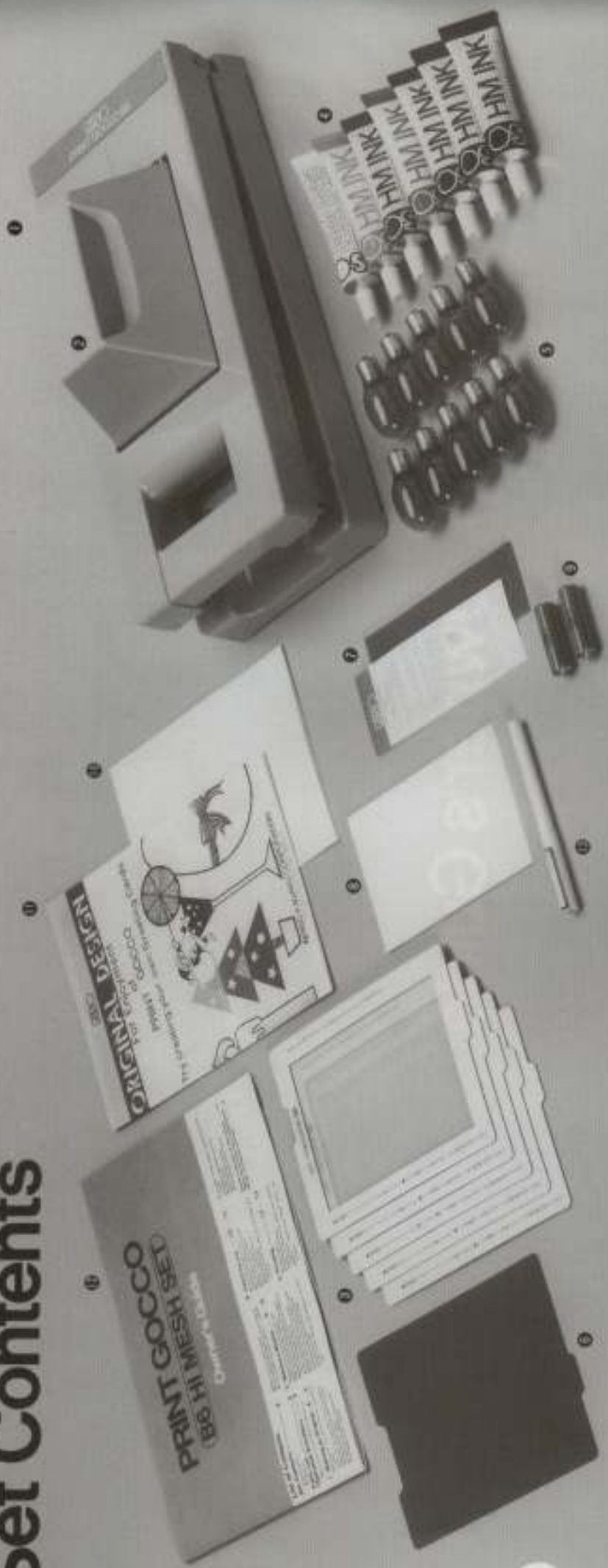

# Set Contents



## Read carefully before using this product

Thank you for purchasing this Print Gocco B6 set.

The Print Gocco is a small, easy-to-use printing press for making card-size color prints. It features a strobe flash master-making system which allows you to print a wide variety of hand-made originals, and to make Hi-Mesh Masters with a simple, one-touch flash process.

This set allows simple alignment of several master for multi-master prints, and protects against misflashing. In addition, High Mesh Masters allow clearer printing of fine characters, of finely drawn lines, and of solid blocks of shading.

**Read the instructions in this booklet carefully before using, and follow the steps outlined. The Print Gocco can be used for children, but first carefully explain to them how to use it.**

## Set Contents

- Please check the following components contained in your Print Gocco B6 set.
- 1 B6 Printer (main body) 1 each
  - 2 Lamp Housing B6 1 each
  - 3 RISO HM Master B6 (master sheet) 1 pack (5 sheets)
  - 4 RISO HM Ink (for paper 40 cc) 1 pack (7 colors: red, yellow, green, blue, brown, black and white)
  - 5 Print Gocco Lamp (bulb) 1 pack (10 bulbs)
  - 6 Print Gocco Filter Blue 1 sheet
  - 7 Print Gocco Ink Blocking 1 sheet
  - 8 Printing Paper B6 10 sheets
  - 9 AA Batteries 2 each

## Specifications

- Printing surface 90 mm x 140 mm
- Dimensions 170 mm(W) x 380 mm(D) x 150 mm(H) with Lamp Housing
- Weight 1.5 kg
- Power 2 AA batteries

## Cautions

- 1 Try to use the Print Gocco in 15°C - 30°C room temp.
- 2 Keep the Hi-Mesh Master free from humidity and dust. Replace 1 sheet at a time directly from the plastic pack.
- 3 Secure cap tightly and keep out of reach of small children after use. Also avoid storing below freezing point or above 40°C.
- 4 Please store the B6 printer placing a sheet of white paper between the Stage Glass and the pad.



# Parts List

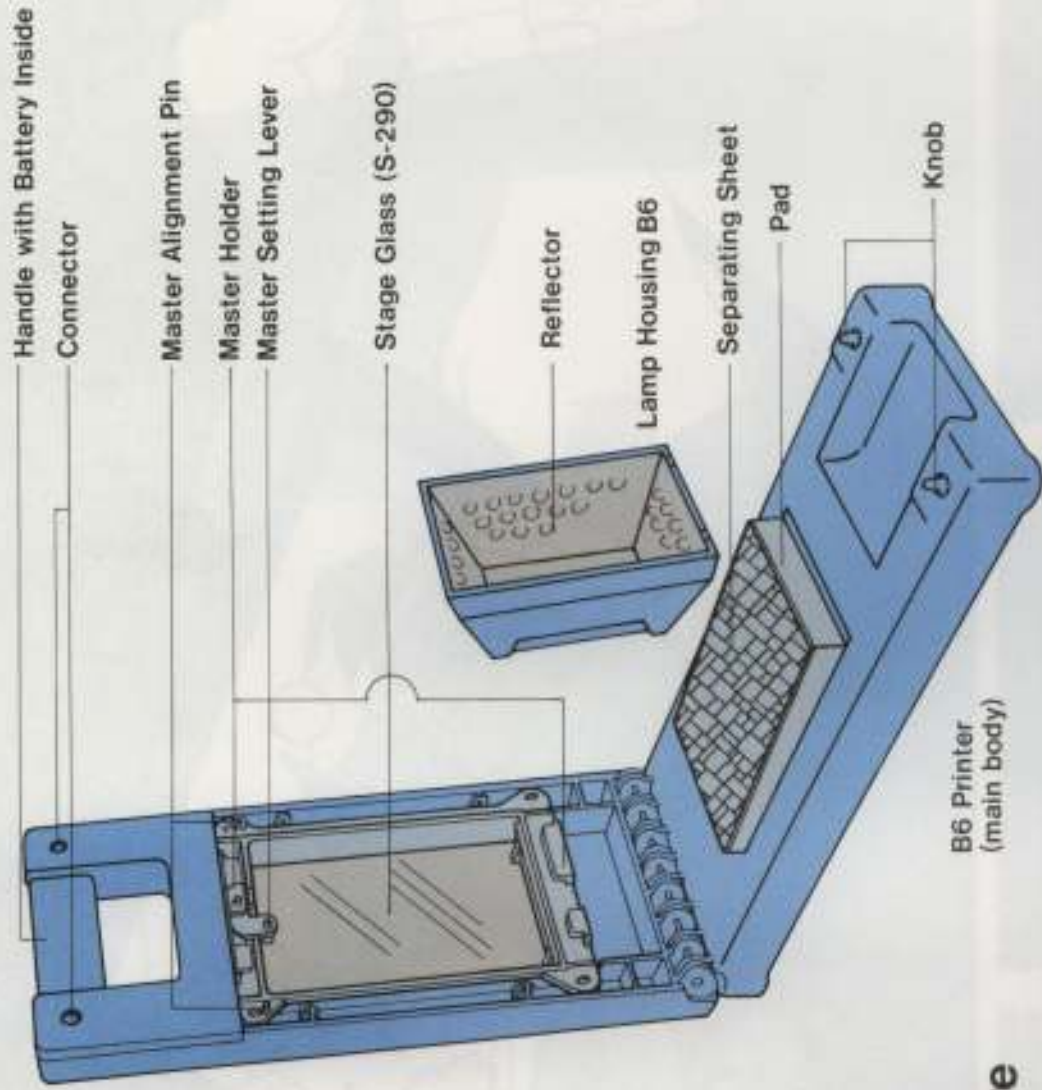

# Operation Procedure



1. Making an original



2. Making a master



3. Applying ink



4. Printing

**Be sure to insert batteries before use.**  
The battery housing cover can be removed by holding the "open" mark with both thumbs and pushing up. After inserting 2 AA batteries as in the diagram, slide the cover back down and insert the 2 hooks into the clamping holes.

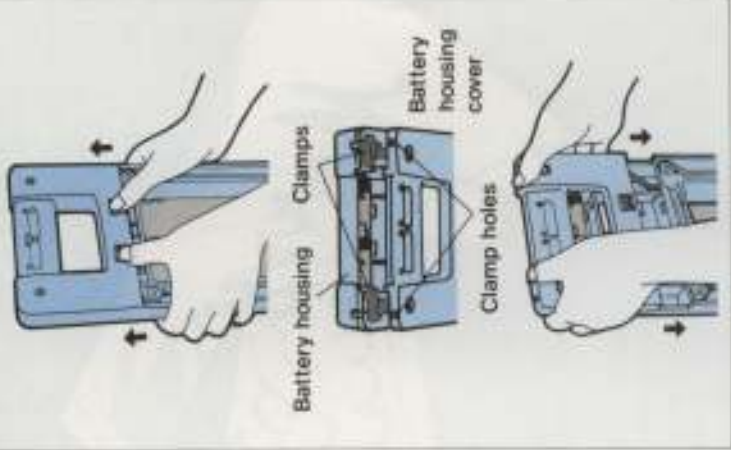

# 1. Making an Original

- Writing etc. with the RISO Pen on the drawing paper.



- Cut out the original, leaving a little extra space around all edges.



## Be sure to use writing utensils containing carbon.

Normal fountain pens, ball point, felt-tip or brush tip pens cannot be used. The Print Gocco is a thermal system which required carbon-contained black colored originals. Be sure to use the following writing utensils.



## Use "Non-Glossy" paper for the original.

Besides the Drawing Papers included in the set, non-glossy (high or medium grade paper) is ideal for originals.

## Writing utensils for use with Print Gocco

**RISO PRODUCTS**  
 Carbon Contained Felt Tip Pen  
 RISO PEN - fine 10.1 mm, 0.3 mm, 0.5 mm)  
 RISO PEN - medium  
 RISO PEN - bold  
 RISO BRUSH PEN

## OTHER MAKERS PRODUCTS

Readily available at stores

**Carbon Contained Felt Tip Pen**  
 Rotring Linograph Pen, Black  
 Edding 1800 Permanent, Black  
 Sakura Pigma Permanent Pen, Black  
**Carbon Ink in Bottle/Cartridge**  
 Higgins #4425 non-waterproof india ink  
 Higgins #613 eternal ink  
 Higgins black magic ink  
 Pelikan fountain ink  
 Pelikan #50 special black drawing ink  
 Pelikan #17 black drawing ink  
 Kohinok #3074 rapidomel ink  
 Kohinok #3080 drawing ink  
 Kohinok #3083-F art pen india ink  
 Parker Washable Ink  
 Faber-Castell art tone fountain pen india  
**Ebony, carbon pencil, Black**  
 HB or B pencil  
 Crayon, black  
 Typed material - with a carbon ribbon

## Note 1:

When using India ink, dilute several times and use on high quality paper only. Be sure to make a master only after drying well.

If using Japanese rice paper, be sure to make a copy first with a PPC copy machine.

## Note 2:

Pencils are not recommended. However, if necessary, use HB or thicker pencils. Please use a hard sheet of plastic or metal underneath. Please tap the completed original with your fingers to remove extra lead powder. Also, be careful not to rub the writing.



- Paste up the cutouts

Scotch tape



#### Pasting up the cutouts (1)

When using glue stick... just dab 1 or 2 areas behind the blank parts of the picture.

- We do not recommend liquid type glue because makes the original wet and dirty.

#### Pasting up the cutouts (2)

When using Scotch tape... secure only 1 or 2 places on the blank edges of the picture. Be careful not to tape over any written or drawn areas.

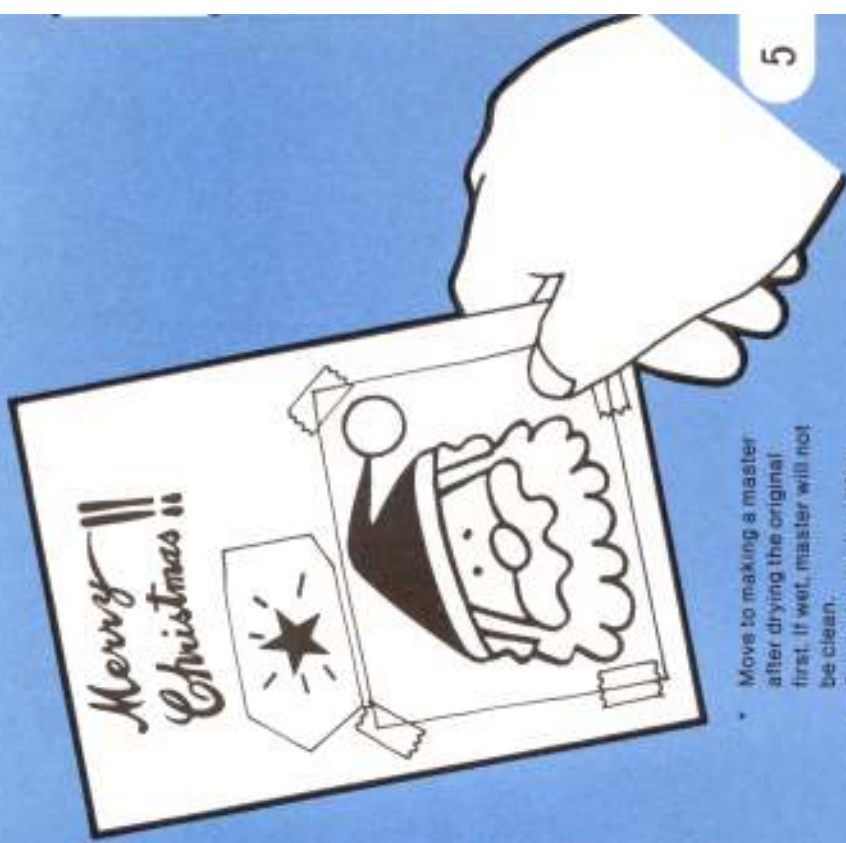
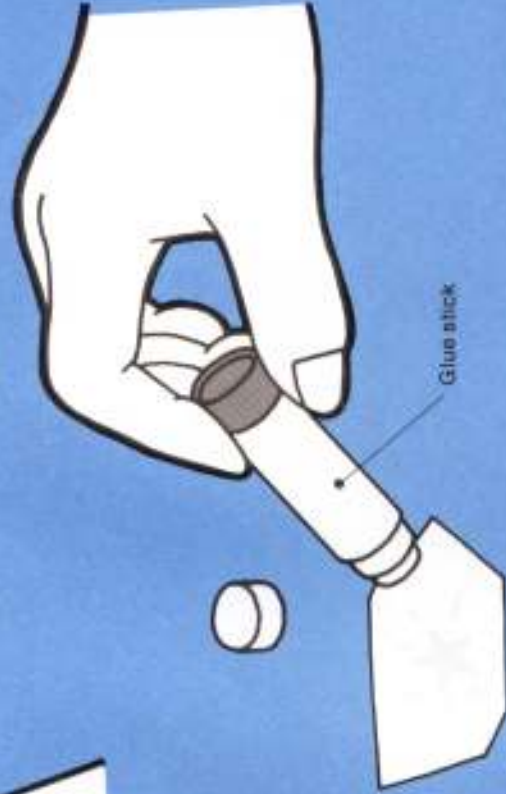

- Move to making a master after drying the original first. If wet, master will not be clean.
- Originals can be either completely hand written or drawn, or created using various pictures.

#### Originals from copies

Such originals as the following can be used if copied first on a PPC copy machine.

- 1 Fountain pen, ball point, felt-tip markers, and colored pencil originals
- 2 Photo, color prints
- 3 Patterned paper, stencil lettering
- 4 Anything else that can be copied

#### Originals using black & white prints

Black printed materials other than provided in the cut collection in the set, can be used as originals for the Print Gocco. Newspapers and magazines can be used, as well, as long as they are non-glossy.

Note: Be careful not to use copyrighted materials for prints for any public and commercial use.

#### Using photos as originals

Use the Print Gocco Photo Screen 65 (sold separately) and copy with a PPC copier first. Then use as the original.

#### When making a draft outline.

First use a red color pencil lightly. That area will not be printed, and therefore does not need to be erased.

#### Eliminating unwanted areas on an original

Put Scotch tape over the area (the covered area will not be printed) or paint over with white correction fluid. Large areas may be cut away with a knife or scissors.

Limit original size within 90 mm x 140 mm

If made bigger than the above specifications, the edges may not be printed. If using the Drawing Paper provided in the set, this will not be a problem.



# 2. Making a Master

- Insert batteries (refer to page 3).
- Remove the transparent film from the Separating Sheet.

Transparent Film



Print Gocco Separating Sheet

- Place a blank piece of paper.

Blank paper



- Place original over the blank paper.

Original

Blank Paper

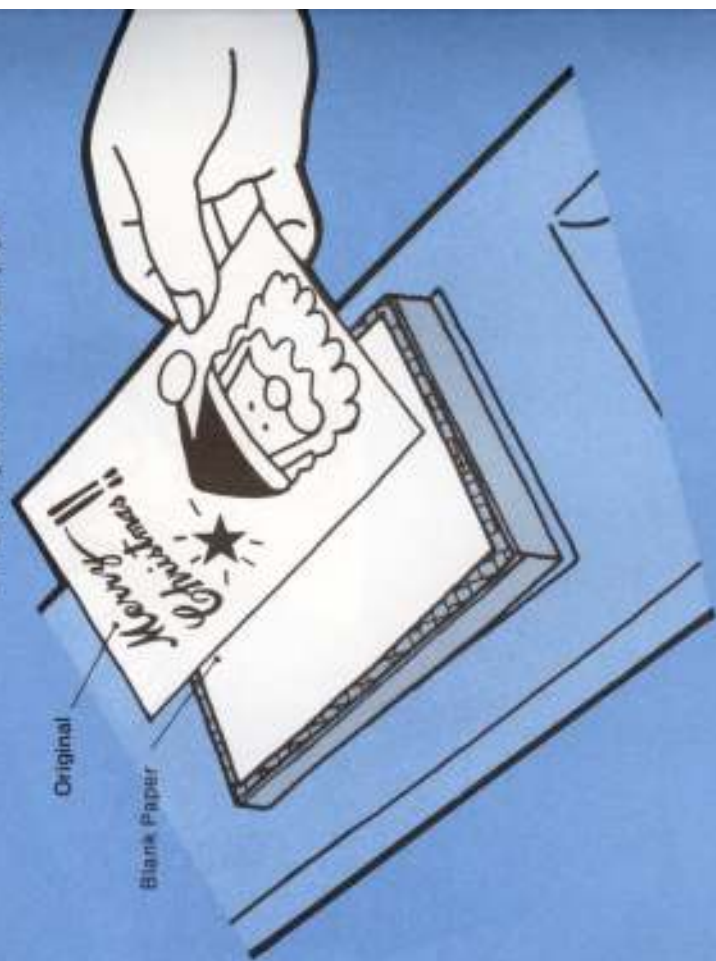

## Handle the Lamp Housing with care.

The bright reflector in the Lamp Housing is essential for good master-making. To prevent fogging of the reflector, remove immediately from the main body after flashing. Furthermore, be careful not to touch the reflector with your hands, etc. Do not look directly into the light leaking from the Lamp Housing when making a master.

## When using important originals.

The original sticks to the master when making masters. Ink is placed on the master using this original. The original will become dirty from the ink leaking from the master. Be sure to copy important originals before making a master.

## Why place a blank paper on the pad?

The Separating Sheet on the pad is adhesive. This is to prevent the prints from sticking onto the master when printing. This is naturally not necessary when making masters. The original must stick onto the master. That is why such a piece of paper is placed between the pad and the original. Furthermore, this sheet can be used as a trial print in the beginning.

Original

Blank paper

Separating Sheet

Pad





# Master-making steps are different, depending on the design original

When your original is an illustration from a collection, or a hand-drawn design

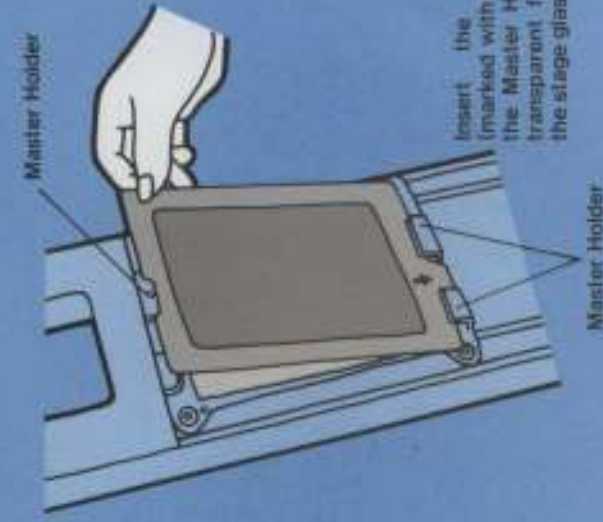

Slightly bending the master, insert the top edge into the Master Holder.

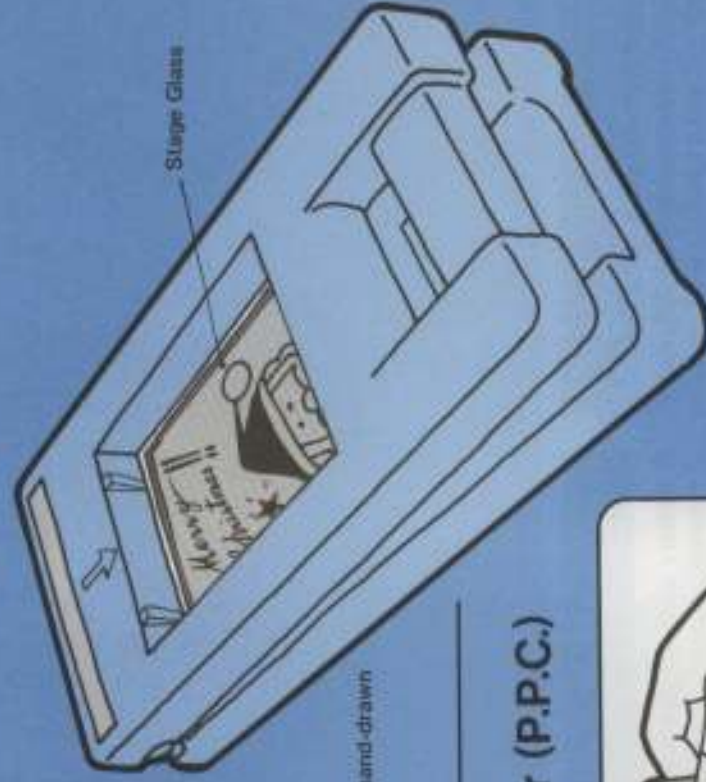

Never use the blue filter when using hand-drawn originals.

When your original is a copy by a plain paper copier (P.P.C.)

Hold the Master with the all blue side up and the arrow pointing down.

Place the blue filter behind the transparent film as shown in the figure to the right. Set the three layers together into the Print Gocco main body, as shown in the above figure.





Lamp Housing



- Insert 2 of Print Gocco Lamp bulbs into the Lamp Housing. Secure the bulbs well by pushing them into the holes firmly, then give them half a twist.

Print Gocco Lamp

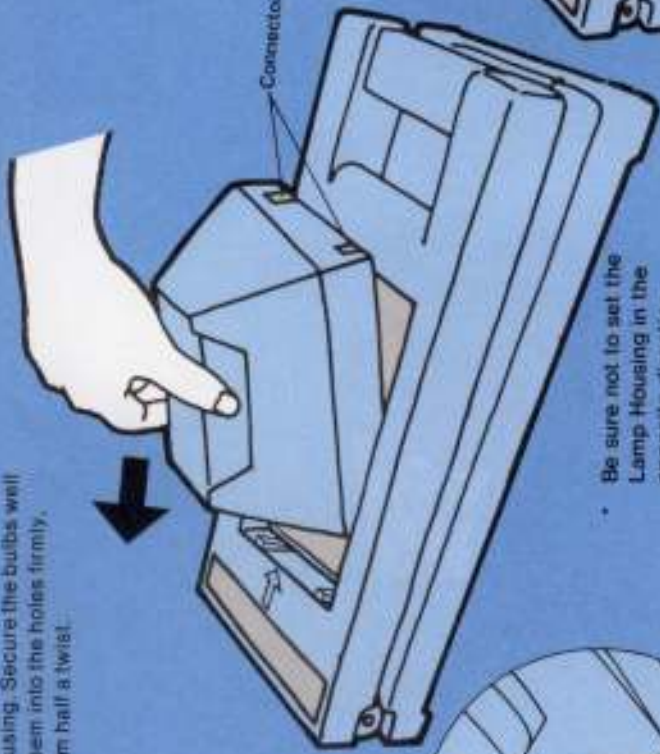

- Push down the connection side and the Lamp Housing is set.



Be sure not to set the Lamp Housing in the opposite direction. Removal becomes difficult.

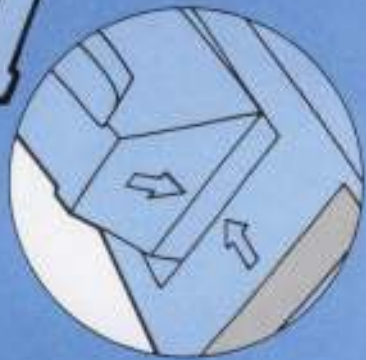

Slide the Lamp Housing into the main body of the Print Gocco. Be sure to line up the arrow-marked side of the Lamp Housing with the arrow on the main body.



**If the Lamp Housing cannot be set**

- 1 Make sure that the master is set. The Lamp Housing cannot be set unless the master is set, as well.
- 2 Make sure that the Lamp Housing is facing in the correct direction. Align the arrows on the main unit as well as the Lamp Housing. With the arrows facing each other, press down on the side with the contact.

**When the Print Gocco Lamp doesn't flash.**

- 1 Battery connections are incorrect. Replace cover, confirm, reset and recover.
- 2 The main body-Lamp Housing connection is improper. Remove the Lamp Housing and reset (refer to the right diagram).
- 3 Not enough pressure on the handle. Depress until the switch and the knob connect completely.
- 4 Batteries are weak. Replace with new batteries.

Improper

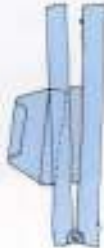

Set properly

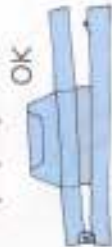

OK

Improper

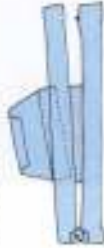

**After flashing, there is no processing.**

- 1 Carbon not contained in the original. Rewrite with proper utensils, or use after copying with a PPC copier.
- 2 The master setting or original placement is incorrect. Read the procedures on pages 6-7 carefully once again.



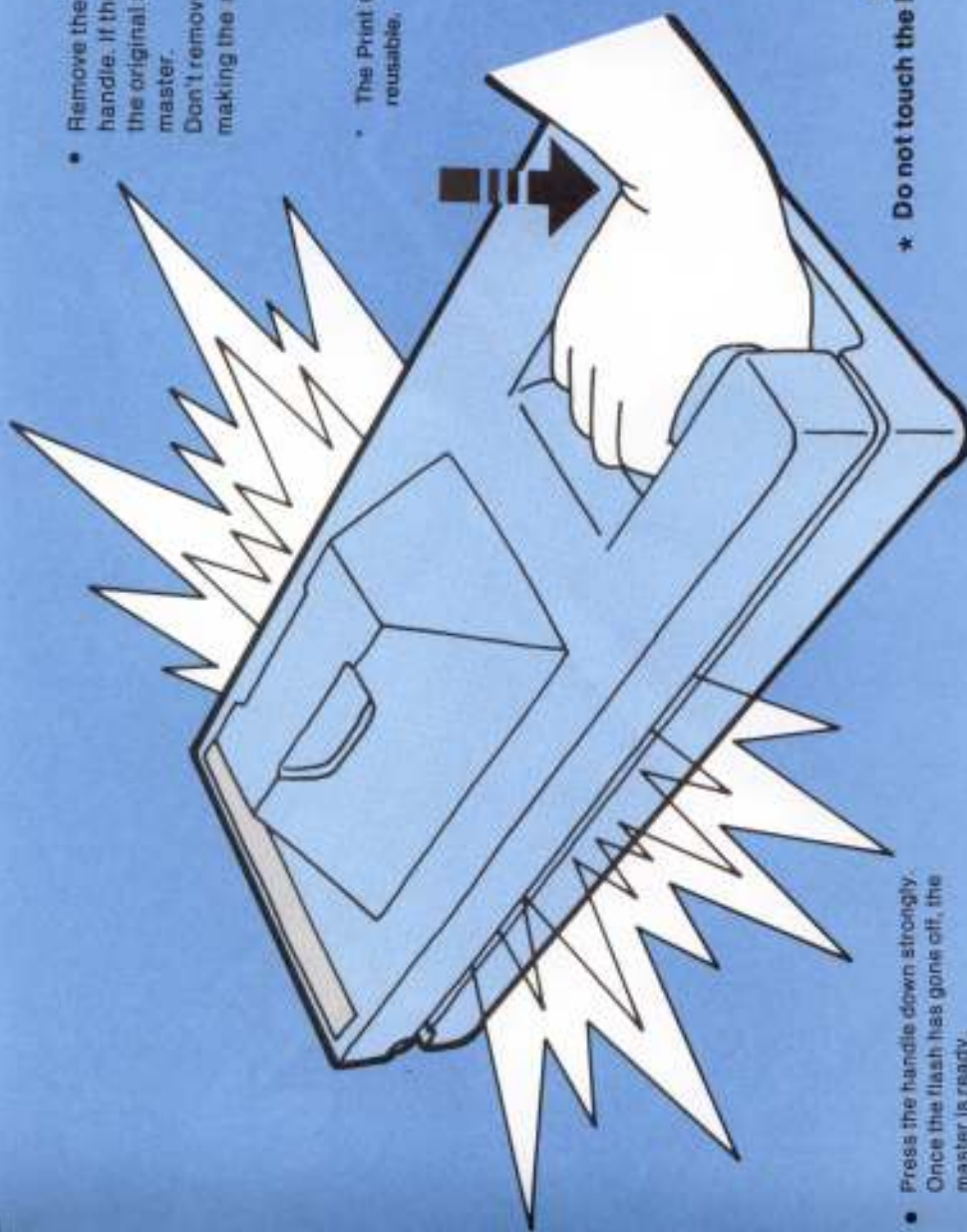

- Press the handle down strongly. Once the flash has gone off, the master is ready.

- Remove the Lamp Housing and lift the handle. If the master is made properly, the original should be stuck on the master. Don't remove the original after making the master.
- The Print Gocco Lamp is not reusable.

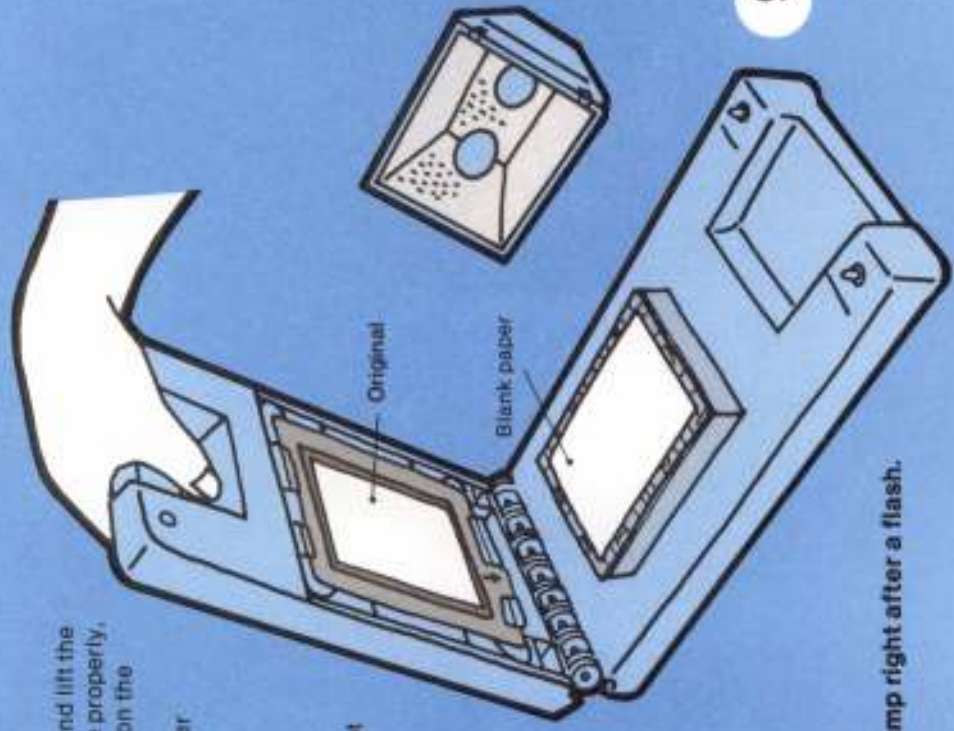

Original  
Blank paper

**CAUTION**  
★ Do not touch the Print Gocco Lamp right after a flash.

**To print on cloth**

Make the RISO Screen Master using the Print Gocco B6 Set, and then print using RISO Screen Kit PG. Print napkins, tablecloths, aprons, matching T-shirts for the whole family—all with the color and creative design that only you can provide.

**Originals with large colored areas**

The original must be dried well in order to achieve good masters. Then place several sheets of soft paper between the original and the pad.

If the lamp flashes, the batteries are still ok

As you use the batteries, they will gradually weaken. However, as long as the lamp flashes when making a master, there will be no effect on master making capability.

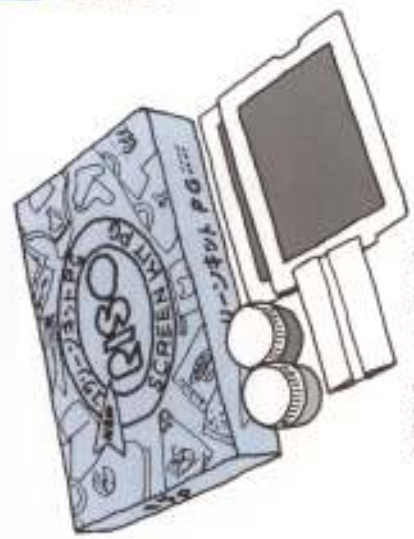

RISO Screen Kit PG



# 3. Applying Ink

- Lift the transparent film.

- Put plenty of ink onto the master where you see black.

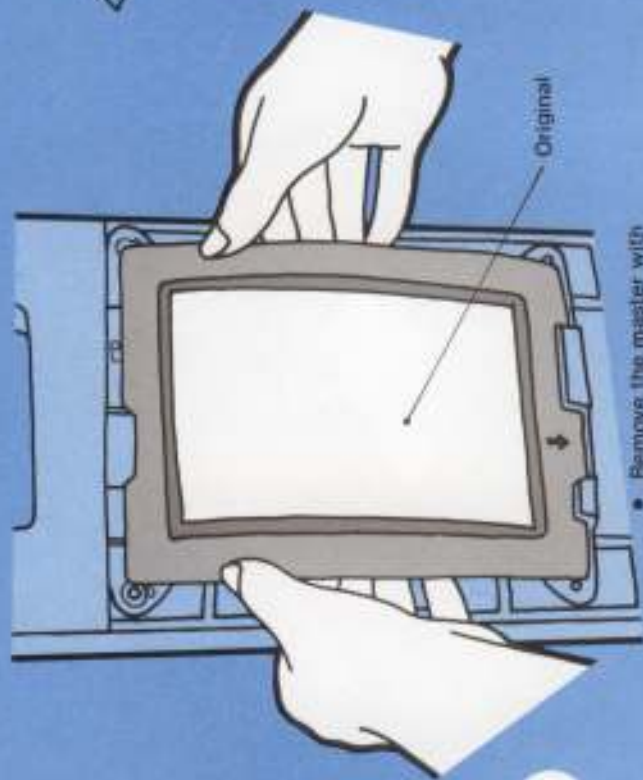

- Remove the master with the original intact.

Transparent film

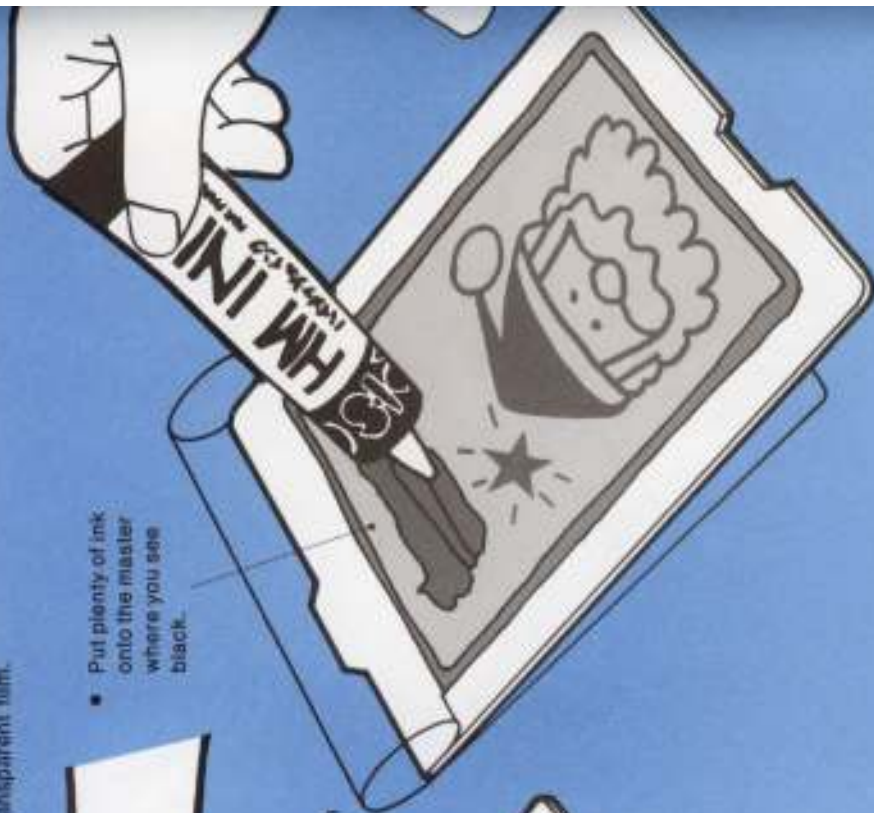

## Put a fair amount of ink

The hint of making successful and clean prints that are not faded, lies in applying enough ink evenly onto the master. When sufficient ink, you can easily make about 70 or 80 consecutive prints without replenishing the ink.

Squeeze on a fair amount of ink. Do be careful not to touch the master with the tip of the ink tube.

## Applying ink where colors meet.

If the edges are relatively separated, there is no need to worry too much even if inks of different colors are placed close together – they will not mix. However, when the edges are very close to each other or where there is more than one color or where there is more than one color to a drawing, place the ink carefully and evenly in the area where the colors meet.

## Separating colors clearly.

Use the "Print Gocco Ink Blocking\*" to prevent the spreading and mixing of ink. Remove the protective film from the adhesive surface of the Ink Blocking, and stick it directly on the inking surface of the master. Clean color separation can be achieved if placed before inking.

Ink Blocking

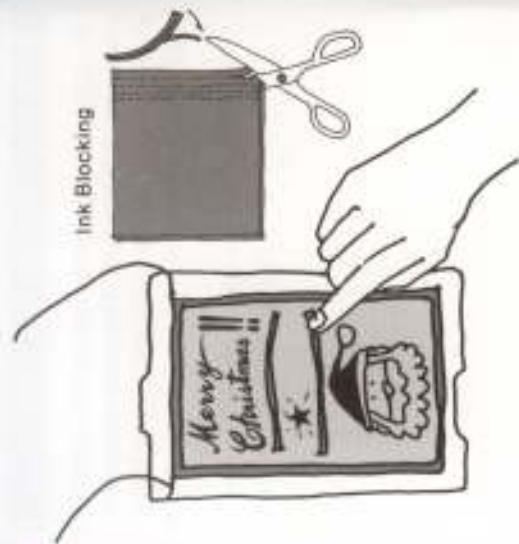



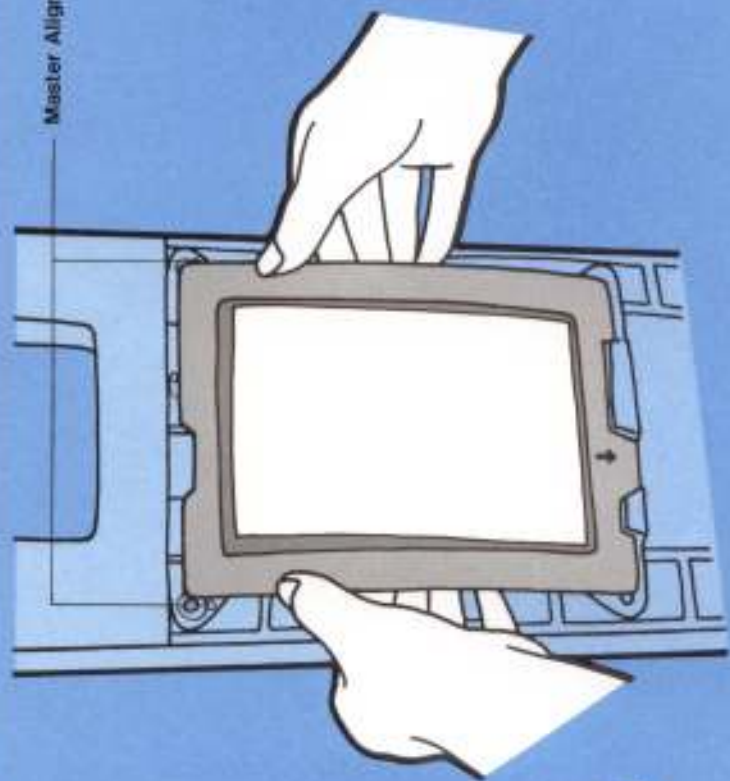

- Fit the master back onto the main body.

- Put any color ink you desire over the master — you can still see the original through it.

- Lower the transparent film back in place.

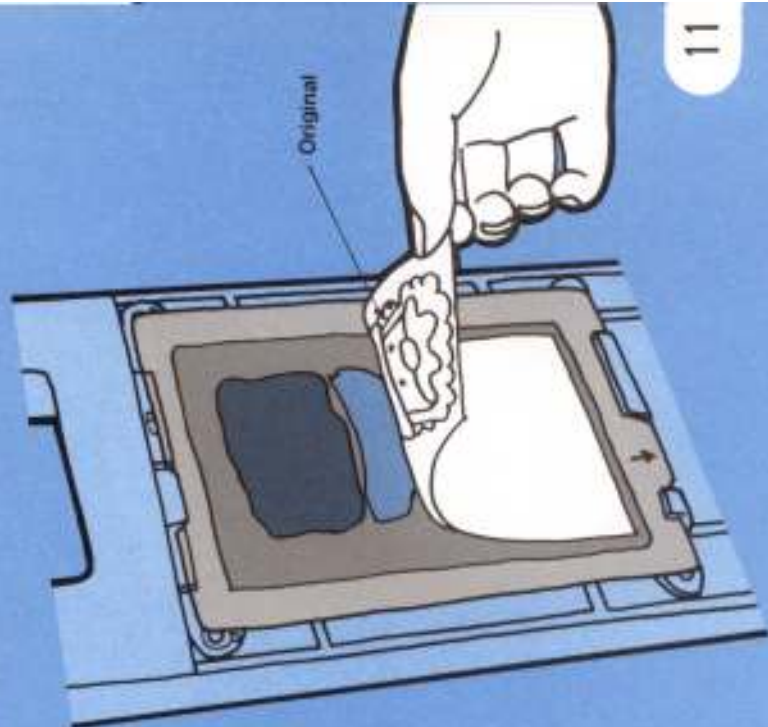

- Peel off the original from the master.

#### When mixing inks.

The ink provided can be mixed in any combination to achieve the color you want. When white is mixed, a very soft texture can be obtained. Squeeze out ink on a palette or a piece of thick paper and mix with a palette knife, etc.



#### When applying mixed ink.

Place the ink directly on the master with the palette knife used for mixing. Use the end of a match stick for fine details. Another way of placing mixed ink is to put the ink on a thick sheet of film with the palette knife and squeeze it out after rolling it, just like icing a cake.



#### Replenishing ink.

When the ink begins to fade while printing, the ink is running out. Remove the master from the main body, lift up the transparent film, and replenish ink. For areas in which the ink has begun mixing, wipe off the ink and replace it entirely with a new coat. The ink can be removed very easily if wiped off with rounded paper. Be sure to wipe off ink on the transparent film, too.

**What to do if ink gets on your hands and clothes.**

Use the "Riso Cleaner" (sold separately) if ink gets on your hands. If on clothes, wash the area with laundry soap in warm water. If stains still cannot be removed, dry-clean.



# 4. Printing

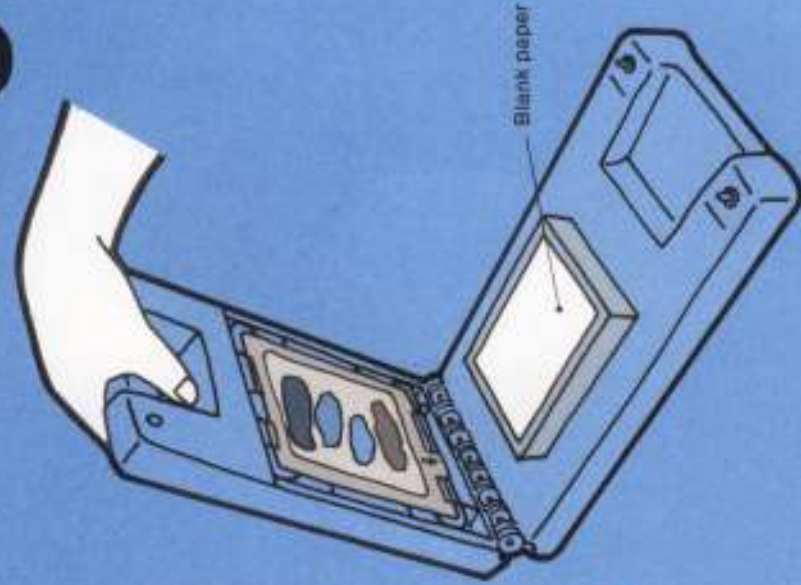

12

- Do a first print by pressing the handle down.



- Use the white paper used when making the master as a trial print.

## Colorful prints

- 1 Very sophisticated and professional prints can be made using two masters. Print the background first using a light color. Then print characters or drawings using a darker color over it. (Two-master printing)
- 2 Fine effects can be achieved when other types of paper are used for printing, such as Japanese rice paper, colored paper, bond paper, etc. Paper can be bought at art supply stores.

## To keep prints clean.

If you stack the freshly printed cards on top of each other, the ink will make the reverse sides of the cards dirty. Put the cards in-

between the pages of an old magazine or place them properly on the "Print Gocco Card Holder" (sold separately). The holder can also be used as a pen stand. Prints can be dried effectively without taking up much space.

## When a Separating Sheet has become inadhesive.

Wipe the surface with a damp cloth to recover its original adhesiveness.

### Note:

**Do not use the RISO Cleaner, because Separating Sheet will become more inadhesive.**

## When a separating sheet sticks too strongly

When the separating sheet adheres too strongly to the paper being printed, (causing the paper to curl when pulled away,) cover the center of the pad with a strip of paper.



## Cut edges of the original appearing on the master.

Can be corrected by using the "Print Gocco Master Correction Fluid" (sold separately) or with a piece of Scotch tape covering the damaged area on the master.



- Remove the first print from the pad and check for problems with inking and other print conditions.

First Print

- If OK, begin printing one sheet at a time.

**Problems with spots and dust.**

- 1 Using an original duplicated with a PPC copier for master-making. Do not fail to use the Print Gocco Filler Blue, as described in the lower section on Page 7.
- 2 Original is dirty. Use white correction fluid or rewrite on another piece of drawing paper.
- 3 Dust on the master. Please do not remove the master until just before use.
- 4 The original prepared in pencil is rubbed or lead powder is spread. Use white correction fluid or remake the original.

**Faded prints.**

- 1 Original still wet when master-making. Be sure to dry completely before master-making.
- 2 Used glossy paper for original. Remake the original or copy it.
- 3 The characters or the drawings on the original are depressed. Remake the original again placing a hard, smooth surface underneath, or copy with a PPC copier.
- 4 The original itself is light and not clear. Rewrite on top of the original again using utensils containing carbon.

6 Not enough ink.

Lift the transparent film and replenish ink.

7 Not enough pressure on the handle. Press harder!

**Storing inked masters.**

The master can be preserved for several days even during printing if sealed properly in a plastic bag.

**Discarding finished masters.**

Wrap them directly in an old newspaper and throw them away. Be careful not to dirty your clothes or hands with ink.

- Do not stack the cards. Dry them for 10 or 15 minutes.

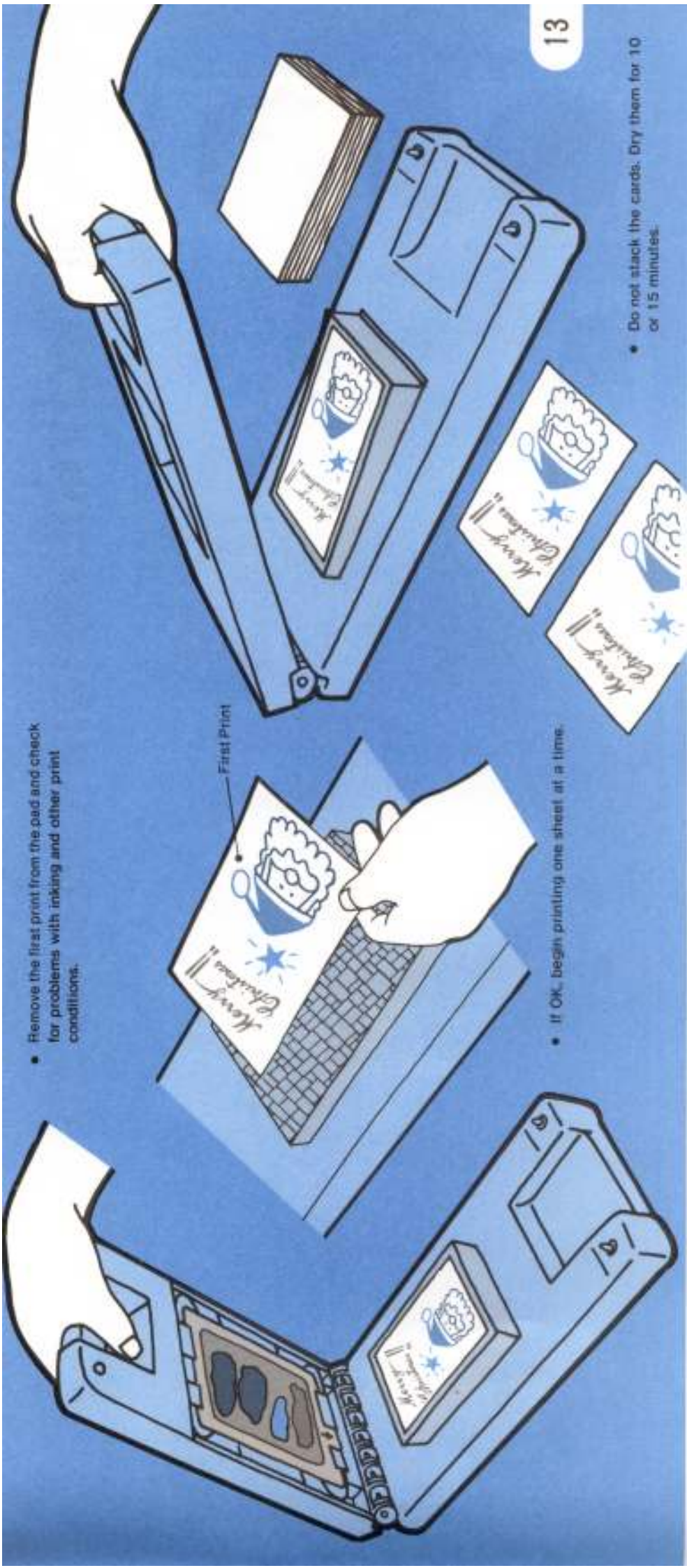



# Several Techniques for Print Gocco

• Please refer to Gocco Design Encyclopedia.

## Pointillism Technique

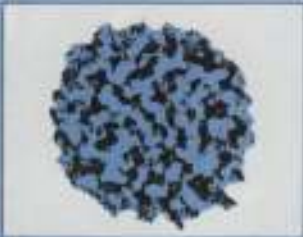

Example after printing



Applying the Pointillism Technique

## Patterned Paper



Example after printing



Use bold and medium screens drawing on Screen Tone with poster color

## Rainbow Technique



Example after printing



Applying the Rainbow Technique

## Two-master Printing



First master (with crayon)



Second master



Second master



Completed print with 2 masters

## RISO Print Powder Technique



Print Gocco Powder (light, silver and black)



Sprinkling the powder over the desired part



Tapping the paper from the back to remove excessive powder



Turn from the back

## Printing on cloth using Print Gocco and Screen Kit PG



RISO Screen Kit PG



RISO Screen Kit B color



1. Set the Print Gocco (kit set)



2. Apply ink to the screen.



3. Set the Screen Master (When using the PG-701)



4. Blot a last print



5. Place a piece of cardboard or white paper beneath the cloth and print



6. Cover with a piece of thin paper and print



7. Press the original the pad



8. Finished all



9. Pull (turn) the screen to back





# Handy-to-have Print Gocco Replacement Goods, Accessories and Parts

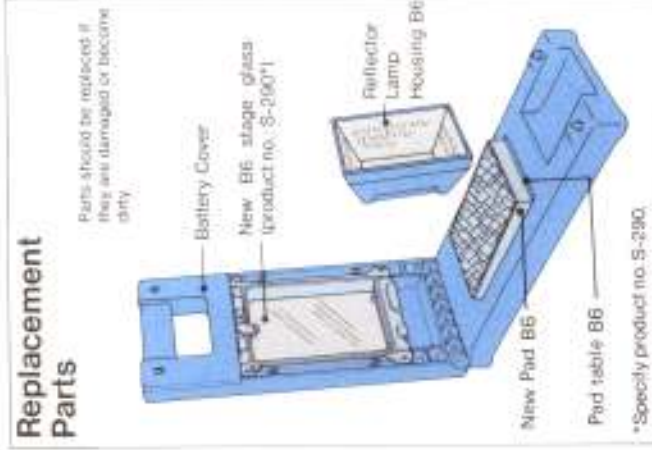
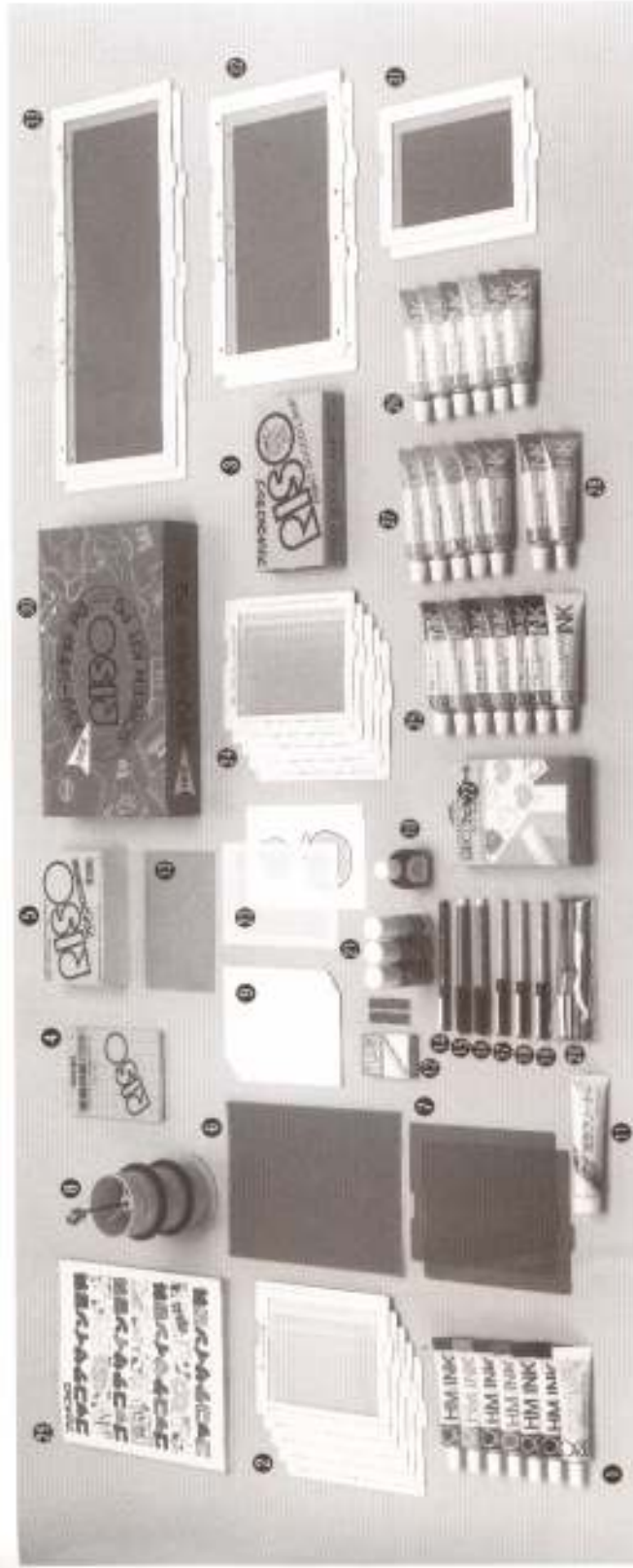

## Replacement Parts

Parts should be replaced if they are damaged or become dirty

Parts should be replaced if they are damaged or become dirty

Handy replacement and accessory items vital in expanding the possibilities of your Print Gocco.

Consumables in this package are available separately

- 1 RISO HM Ink (40 cc) — for paper
- 2 RISO HM Master B6 (128 x 182 mm) (5 sheets per pack)  
Using HM Master (2) with HM Ink (1) supplies the beautiful print especially delicate illustrations or lettering.
- 3 Print Gocco Lamp (10 bulbs per box)
- 4 Drawing Papers Card Size (50 sheets per volume)
- 5 Printing Papers Card Size (200 sheets per box)
- 6 Print Gocco Ink Blocking
- 7 Print Gocco Filter Blue (2 sheets per pack)

These goods make your printing efficient.

- 8 Print Gocco Gocco Card Holder  
Clamps your prints and dries them.  
(Can also be used as a pen stand.)

Print Gocco Adhesive Layout Sheet  
Use this layout sheet to easily create complex designs by gently pressing cutouts onto the adhesive surface.

RISO Correction Fluid  
Used on the master to erase unwanted areas and spots.

RISO Cleaner  
Cleans the ink off your hands and other unwanted areas.

Print Gocco Separating Tape (10 sheets per box)  
Adhesive tape to hold print on pad for easier printing.

Print Gocco Separating seat  
Adhesive seat to hold print on B6 pad; can be used semi-permanently.

These pens are prepared especially for Print Gocco

- 1 RISO Blush Pen  
Non-cartridge type brush pen
- 2 RISO Pen: bold  
Besides drawing bold script, it can be used for drawing regular lines with its tip.

RISO Pen: medium  
Suitable for medium script and all over coloring

RISO Pen: fine (0.1, 0.3, 0.5)  
Fine point pen suitable for delicate illustrations or lettering

RISO Pen Set  
Fine point pen set containing 0.1 mm, 0.3 mm and 0.5 mm

These goods promise you attractive printing result

- 1 Print Gocco Powder (Gold, Silver, Clear)  
Beautiful gold and silver effect when sprinkled on the printing surface and heated.
- 2 Print Gocco Felt Sheet  
Heat transcribes flocking to the surface previously printed with the Print Gocco.
- 3 Print Gocco Photo Screen 65  
Screen for making copies from pictures

These goods undoubtedly help making your printing colorful finish

- 4 Print Gocco Master B6 (128 x 182 mm)  
Standard type master as usual (5 sheets per pack)

Print Gocco Ink (40 cc) — for paper  
7 colors (Red, Yellow, Green, Blue, Brown, Black and White)

Print Gocco Ink (40 cc) Light Color — for paper  
Convenient light color inks for the background of the first printing.

Print Gocco Ink (40 cc) Fluorescence — for paper  
Expecting the conspicuous effect, these produce the vivid printed area

Print Gocco Ink (40 cc) Gold, Silver — for paper  
Elegant matted gold and silver color

Print Gocco Gocco Design Encyclopedia  
Shows effective use of Print Gocco.

RISO Screen Kit PG  
Kit for printing on cloth

RISO Screen Master PG-701/702/703  
PG-701: 90 mm x 140 mm (approx.)/  
PG-702: 180 mm x 140 mm (approx.)/  
PG-703: 270 mm x 140 mm (approx.)

Can be used as is with the Print Gocco.





RISO KAGAKU CORPORATION

C.P.O. BOX 132 TOKYO, JAPAN

5-347 SHIBA, MINATO-KU, TOKYO, JAPAN

PHONE: 03(544)6981 TELEX: (353)2298 RISO J FAX: 03(544)6666